

weberend MT

Thin coat render system for use on approved carrier boards

- BBA approved system
- Ideal for timber/steel frame applications

About this product

weberend MT is a high performance, multi-coat render system, incorporating glass-fibre meshcloth, a resin-rich adhesive coat with a choice of textured finishes in a wide range of colours.

The system render base coat is polymer-modified, which helps it to retain some flexibility. Mesh reinforcement between the two base coat layers provides extra impact resistance.

The render system can be finished with **webersil TF** or **weberplast TF**, light textured finishes or **weberwall brick** our brick effect system.

Features and benefits

- BBA approved system
- Large areas can be rendered on render boards without the need for expressed joints
- Allows previously uneven masonry substrates to be rendered and gives a high level of crack resistance
- Wide choice of colours and textures available, including brick effect
- A2 reaction to fire when finished with **webersil TF** or **weberwall brick**, B reaction to fire when finished with **weberplast TF**

Uses

- For use on timber or steel framed buildings
- Designed for application on to an approved panelled background with a choice of textured finishes in a wide range of colours



WEATHER
RESISTANT



BBA APPROVED
SYSTEM



up to
A2 REACTION
TO FIRE

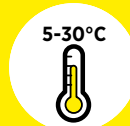

5-30°C
APPLICATION
TEMPERATURE

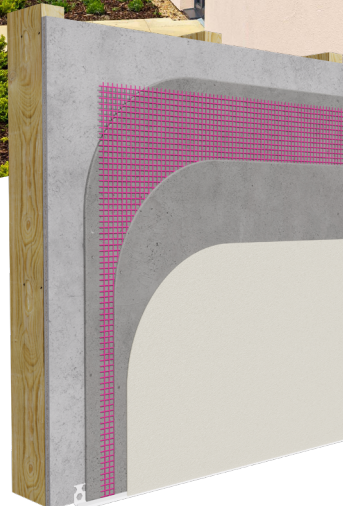

System component	Datasheets
weberend OCR	Click here
weberend LAC rapid	Click here
weberend LAC	Click here
webersil TF	Click here
weberplast TF	Click here
weberwall brick external adhesive	Click here
weberwall brick	Click here
weberwall brick pointing mortar	Click here
weber CL150	Click here
weber PR310	Click here
Approved render boards	Click here

Materials

Levelling coat (or masonry where required)

weberend OCR is a cement-based render that can be applied up to 20mm thick in one or two passes.

Mesh cloth

Balanced, open weave alkaline resistant glass fibre mesh:

Weight	160g/m ²
Mesh dimension	3.5mm x 3.5mm
Size	1m x 50m roll

Adhesive coat

weberend LAC and **weberend LAC rapid** are factory batched mortars for scrimming.

Primer

weberend PR310 is a pigmented liquid paint and is an effective method of preparing substrates by reducing suction and providing a colour wash prior to the application of the chosen textured finish.

Synthetic textured coatings

A range of textured coatings is available in over 100 colours.

Preparation

Approved render boards

Ensure boards are securely fixed to frame, providing a rigid in-plane surface without deflection or edge protrusions.

Existing masonry substrates

Treat surfaces with **weber CL150**, a biocidal wash, to remove any traces of organic growth.

Where there is inadequate key, apply **weberend aid** as directed on the data sheet.

Mix and apply **weberend OCR** to produce a level in-plane background. Lightly brush scratch and allow to dry. Refer to the product data sheet for further information.

Application

Mix and apply **weberend LAC/weberend LAC rapid** coating approximately 3mm thick. Lay in the meshcloth and apply a further 2-3mm of **weberend LAC/weberend LAC rapid**. Sponge finish to achieve a flat finish. Allow to dry.

If using **weberend LAC**, prime the surface with the appropriate primer. **weberend LAC rapid** does not require a primer.

Apply the selected textured finish.

In order to achieve high quality results, always refer to the individual Product Data Sheets before starting any work.

Do not apply

- If frost is forecast within 24 hours of use
- In damp/wet conditions
- In temperatures below 5°C or above 30°C
- On elevations in direct sunlight or where the substrate is hot

Constraints

The quality of application of these materials depends on suitable operative skills and product familiarity.

Restrictions on weather conditions during application and curing must be respected.

Sound trade practices and printed instructions must be followed.

Good access and appropriate protection must be provided.

Prior to the installation of our **weberend MT** system please ensure that you contact the manufacturer of the proposed compatible substrate boards to obtain their fixing recommendations and ensure that the boards suitability in withstanding the necessary wind loading requirements for your specific project.

Health & Safety

For Health & safety information please request the relevant Material Safety Data Sheet from Weber.

For technical advice phone: 01525 718877 or email technical@netweber.co.uk

Technical data

weberend MT system on a panel background

Board	1st pass	Reinforcement	2nd pass	Primer	Finish
Approved render board	weberend LAC rapid or weberend LAC	weber standard meshcloth	weberend LAC rapid* or weberend LAC	weber PR310 (only required if weberend LAC is used)	webersil TF or weberplast TF or weberwall brick

weberend MT system on masonry background

First layer (levelling coat)	Reinforcement	Fixing	1st pass	2nd pass	Finish
weberend OCR	weber standard meshcloth	N/A	weberend LAC rapid* or weberend LAC	N/A	Primer with webersil TF or weberplast TF or weberwall brick*

*Primer not required with **weberend LAC rapid** or for **weberwall brick** finish

weberend MT panel silicone/acrylic system

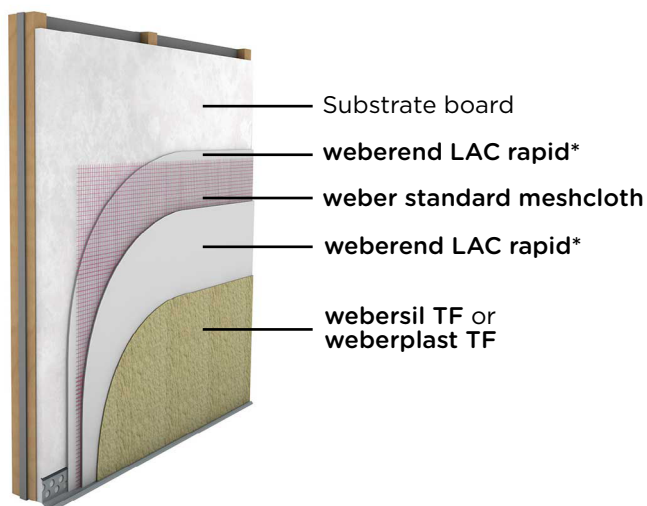

weberend MT panel brick system

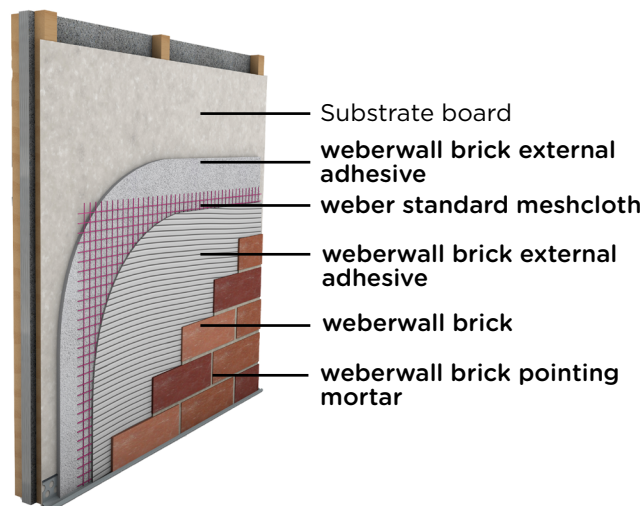

*If **weberend LAC** is specified, **weber PR310** primer must be used before application of the decorative finish

Designers should refer to the relevant building regulations and guidance for detailed conditions of use, in respect to fire performance, cavity barriers, service penetrations and combustibility limitations for other materials and components used in the overall wall construction for example thermal insulation. Cavity barriers must be incorporated as required under the notional Building Regulations although not block the essential ventilation and drainage pathways. Further guidance can be found within BRE Report BR 135 2013

Saint-Gobain Weber
Dickens House, Enterprise Way,
Maulden Road, Flitwick,
Bedford, MK45 5BY

+44 (0) 1525 718877

✉ technical@netweber.co.uk

🌐 www.uk.weber

📱 @SGWeberUK

To the best of our knowledge and belief, this information is true and accurate, but as conditions of use and any labour involved are beyond our control, the end user must satisfy themselves by prior testing that the product is suitable for their specific application, and no responsibility can be accepted, or any warranty given by our Representatives, Agents or Distributors. Products are sold subject to our Standard Conditions of Sale and the end user should ensure that they have consulted our latest literature.

REV. 22/11/23